

Operating Instructions

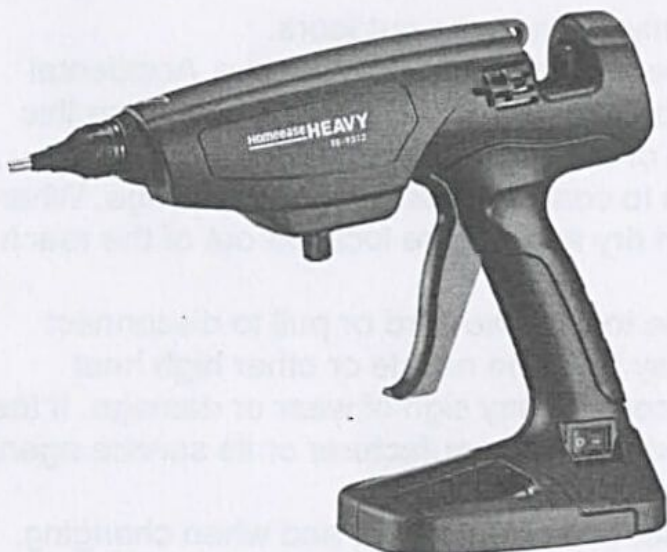

**Professional - Heavy Duty – Industrial
Hot Melt Glue Gun**

Model: TE-9312

Specification:

Power rating: 220-240 VAC, 50/60Hz, 300W

Operating Temperature: 130°C-230°C (265°F-445°F)

Only for suitable glue stick tolerance: \varnothing 11.0mm - \varnothing 11.5mm

Warning Note:

- 1. This appliance is not intended for use by persons (including children) with reduced physical, sensory or mental capabilities, or lack of experience and knowledge, unless they have been given supervision by a person responsible for their safety.**
- 2. When using this hot melt glue gun, always follow basic safety precautions. This will reduce the possibility of accidental injury due to burns or electrical shock.**
- 3. Always wear safety glasses and protective gloves and clothing. Long sleeve shirts and pants.**

Read all Safety Instructions:

- This glue gun must be grounded.
- Work area. This tool is designed to be used on a clean, dry work surface. Excessive dust and dirt may reduce the lifetime of this tool. Do not use in wet or damp locations. Your work areas should keep well lit.
- This tool is recommended for indoor use only. Do not use outdoors.
- Keep children away. Small children must be kept away from work area. Accidental contact with tool or extension cord should be avoided. Children should not use this glue gun, only under the direct supervision of a responsible adult.
- Glue gun storage. After use, allow glue gun to cool completely prior to storage. When not in use, the glue gun should be stored in dry and secure location out of the reach of children.
- Electrical cord precautions. Do not carry the tool by the cord or pull to disconnect from the electrical point. Keep the cord away from the nozzle or other high heat sources. Periodically inspect the electrical cord for any sign of wear or damage. If the power cord is damaged, it must be replaced by the manufacturer or its service agent or a similar qualified person in order to avoid a hazard.
- Disconnect electrical power when not in use, before servicing, and when changing. Do not pull the power cord to unplug from electrical point.
- Stay alert. Pay attention to your work. Beware of any dripping hot glue from your project. Use common sense. Do not operate this gun when you are tired. Do not operate under the influence of alcohol or other drugs that may impair your physical abilities.
- Do not touch the heated nozzle of the glue gun or the hot adhesive. The operating temperature of this tool is 383°F (195°C).
- Use recommended accessories. Use only recommended adhesives in this glue gun. Insert glue stick other than recommended materials may result in accidental injury and permanent damage to the glue gun. For example: do not attempt to melt crayons or candles.
- Never use the tool if it is damaged in any way. Hot melt adhesives are not a replacement for structural fastener.
- Hot melt glue should not be used for projects that will be exposed to extreme heat. Some adhesive used with this glue gun can soften at about 140°F (60°C).
- Do not remove unused glue stick from the tool. Just snip unused portion.
- Do not expose the glue gun to extreme changes in temperature during or directly after use. Never immerse glue gun in water or other liquids to speed cooling process. Allow the gun to air cool only.
- Do not use glue gun in explosive environment or nearby explosive materials.
- Do not leave the glue gun unattended while plugged in or in a hot condition.
- Do not dispose of electrical appliances as unsorted municipal waste, use separate collection facilities.
- Contact your local government for information regarding the collection systems available.
- If electrical appliances are disposed of in landfills or dumps, hazardous substances can leak into the groundwater and get into the food chain, damaging your health and well-being.
- When replacing old appliances with new one, the retailer is legally obligated to take back your old appliance for disposal at least for free of charge.

TE-9312 Special features:

- 300 watts for greater glue output than other glue guns
- Solid handles and light weight
- Unique effort-saving trigger, with circular soft handle for comfortable long hour operation
- Adjustable temperature design: work with the right temperature for the required glue properties. Temperature is adjustable between 130°C-230°C (266°F-446°F).
- Stroke adjustor: Each piece comes with a stroke adjustor, and allows user to pre-set the amount of glue output correctly.



Operation

1. Plug the glue gun into any AC outlet with required specification; illuminated red light means power is turned on (some models with simplified switch only).
2. Allow the tool to heat for approximately 3-5 minutes. Insert a stick of adhesive into the back of the tool. You may use 100mm, 250mm or 300mm length glue sticks in this tool. **Use only suitable glue stick within the tolerance range, specified in the cover page of this manual.**
3. When the gun is fully heated, pull the trigger slowly, until the melted glue begins to flow from the nozzle. Release the trigger to stop the glue flow.
4. Certain models can adjust the output volume by a stroke adjustor screw.

Preventive Maintenance

1. To prevent blocking of the glue gun, keep feeding mechanism and melting chamber free from dirt and debris. Store unused sticks in a clean environment.
2. Do not pull glue stick from the back of the glue gun. The feed mechanism will be damaged. If you desire to change types of glue, cut off unused end and feed the remainder through with the new type of glue.
3. Do not lay heated gun on its side. Keep the heated gun in an upright position only., with nozzle pointed down.
4. If melted glue has escaped from the melt chamber entrance and is interfering with the feed mechanism; allow gun to cool, and gently remove the obstructing glue.
5. Replace the nozzle if glue drips excessively. Do not attempt to change nozzle when glue is cold. To change, the gun must be heated until the glue is softened

enough to remove nozzle (about 1 minute). Use gloves and with a wrench, remove the old nozzle. Flush glue through the gun, to clean out the melting chamber. Replace with a new nozzle, tighten until locked. Do not over tighten.

6. Nozzle is suggested to be replaced regularly, ensuring a good flow of glue.
7. Keep outside of glue gun clean.

Save these safety rules for future use

1. It is normal for this tool to become quite warm during use. This is normal and does not indicate a problem.
2. The glue gun should be unplugged after use or if it will not be used within 2-hour period. The adhesive can be stored indefinitely in the unheated gun and re-melted by heating up the tool.
3. If you accidentally touch the melted glue, immediately immerse the affected area in cold water and call a doctor. The injured area should be attended by a medical professional.
4. Some materials are heat-sensitive and can be damaged by the hot nozzle or even the hot glue. Whenever possible, test a piece of scrap material or a hidden portion of the object being repaired.

※ The operation of any power tool can result in foreign objects being thrown into the eyes, which can result in severe eye damage. Always wear safety glasses or a wide vision safety mask when working with this tool.

Tips on Using

The following guide provides some helpful information concerning your GLUE GUN TE-9312 and hot melt adhesives.

1. The normal working time of the hot-melt is thirty (30) seconds. After the glue has been extruded onto the surface being bonded, the part should be pressed together within fifteen to twenty (15-20) seconds. The bond will have about 90% of its bond strength in one minute.
2. The working time of the hot-melt can be extended to fifty to sixty (50-60) seconds by applying the adhesive in large drops or shortened to less than ten (10) seconds by extruding the adhesive in a thin line.
3. Large areas are difficult to bond because the adhesive will harden before you have extruded the required amount fully. Apply glue in a small area one by one.
4. Preheating the surfaces being bonded to slightly above room temperature will improve the bond strength. Direct sunlight will accomplish this. This action is particularly important when gluing metal pieces.
5. The hot-melt adheres well to rough surfaces like paper, cloth, particleboard, and pinewood.
6. The hot-melt adhesives quick set time eliminates the need for clamps or other holding devices.
7. The hot-melt begins to soften when the temperature exceeds 140°F (60°C) and should not be used on items that will be subjected to temperatures above that.
8. Hot-melt adhesives can be used in place of nails, staples, tapes, or liquid glue: however, they should not be used to replace structural fastener where heavy loads are involved.

- Glue strings from nozzle. Your glue is stringing from the nozzle you may want to swirl the nozzle in a circular motion, the heat of the nozzle will cut the string. If the glue string lands on your project, allow the glue to dry, then take a hair dryer and blow off the glue string.

Recommended servicing parts

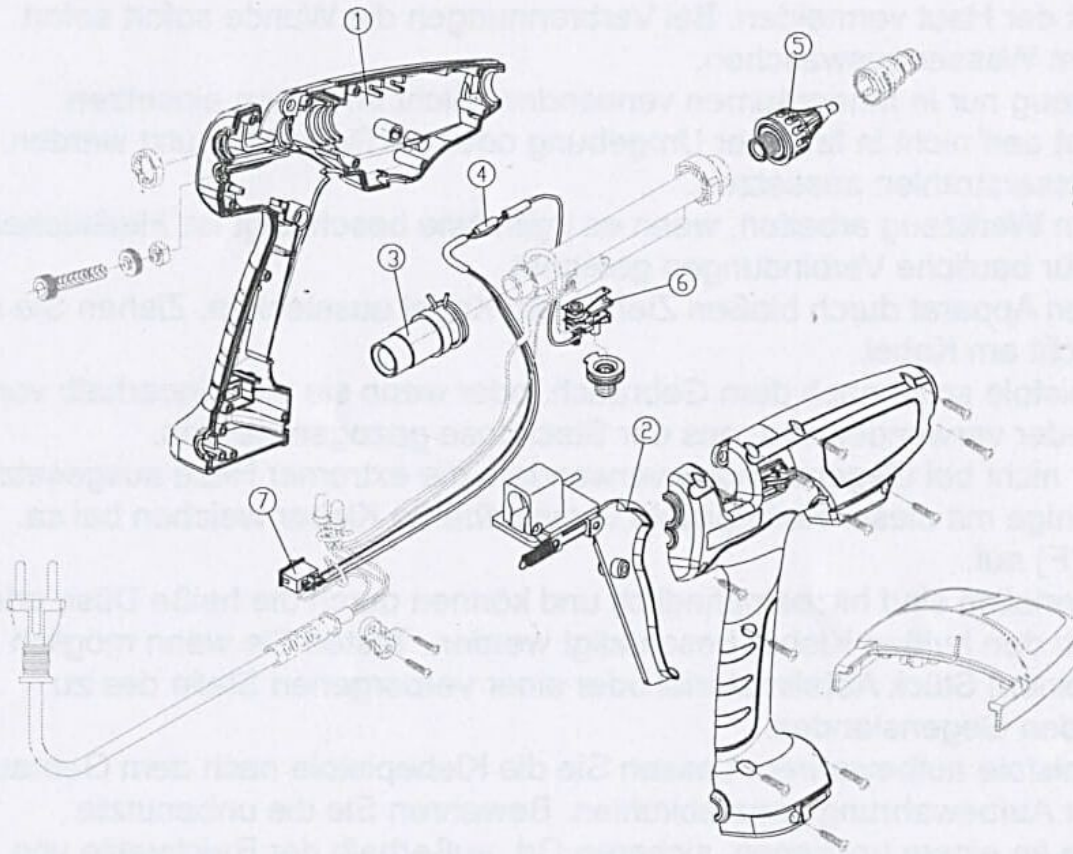

No.	Parts Name.	Parts No.
1	Handle set	2883020
2	Trigger set	2743041
3	Inlet tube set	2252110
4	Temperature fuse set	9002025SG157
5	Nozzle	2331821-B
6	Thermostat set	9002077SB355
7	On/off switch	2154055-R